

BOLTS N°
 φ16x35 2
 φ40 24
 φ45 1
 φ50 2

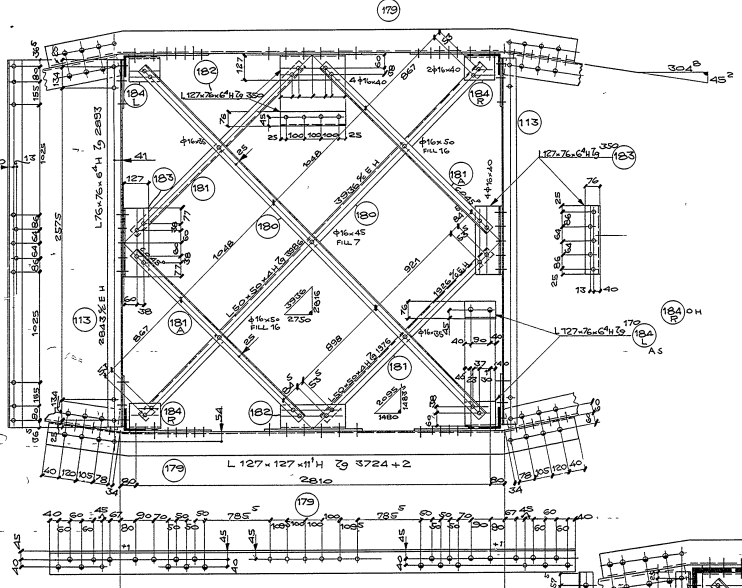

SECTION E-E

BOLTS N°
 φ16x40 26
 φ16x45 1
 φ16x50 2

SECTION D-D

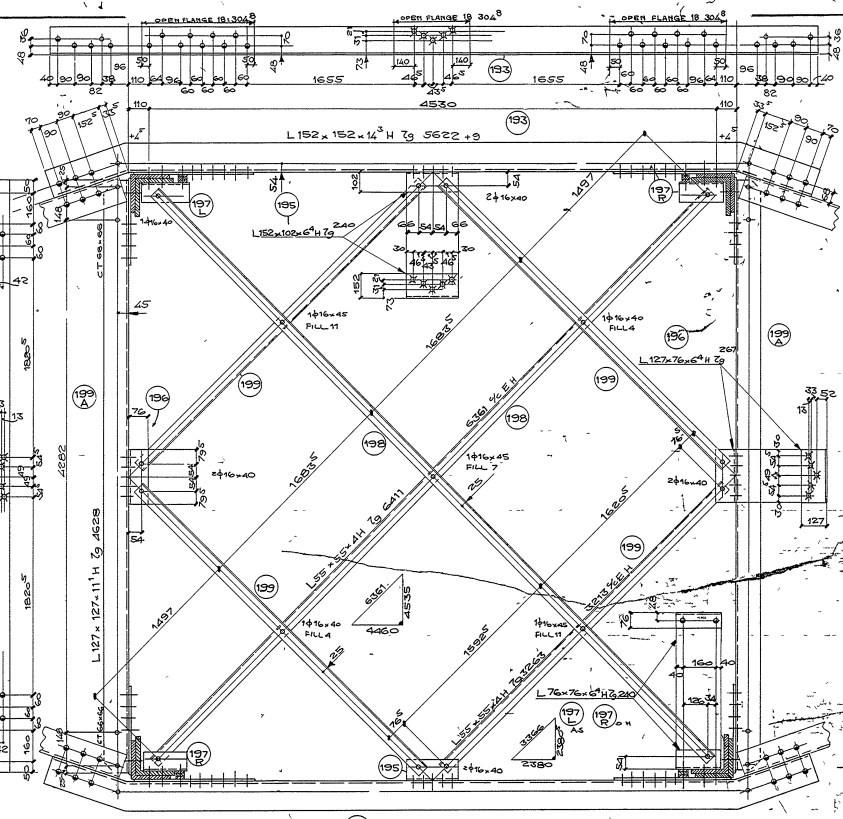
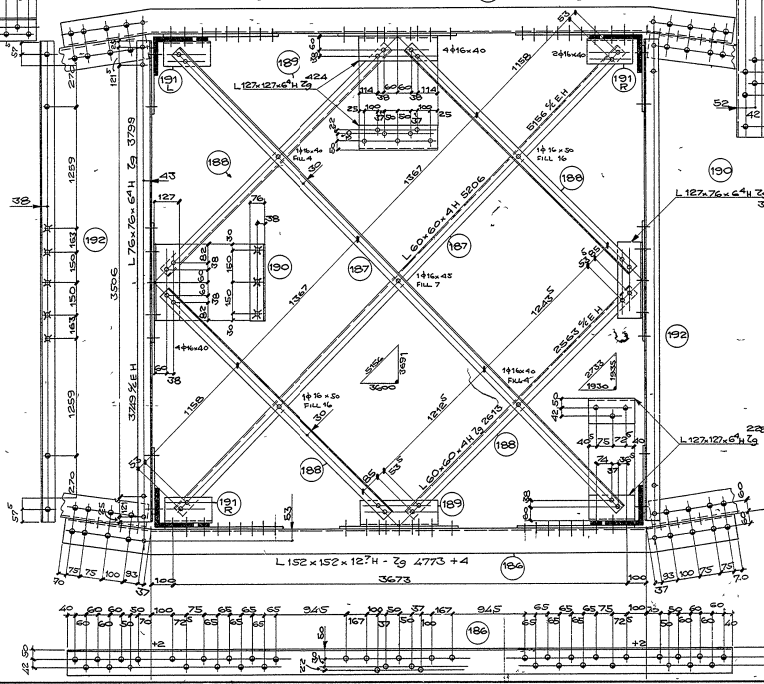
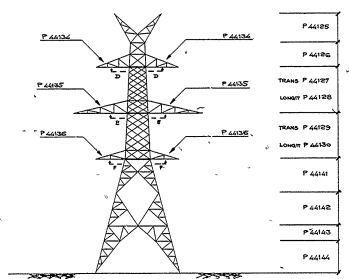

SECTION F-F

BOLTS N°
 φ16x40 14
 φ16x45 3

ΔΙΟΚΤΗΣΙΑ ΔΕΗ

- NOTES
- 1 - For general notes see dwg P.44125 -
 - 2 - For top part see dwg P.44125-P.44130 -
 - 3 - For bottom part see dwg P.44130-P.44135 -
 - 4 - φ 11" dia holes for 16" dia bolts cut edge 25"m unless noted.
 - 5 - φ 21" dia holes for 20" dia bolts cut edge 50"m
 - 6 - φ 26" dia holes for 24" dia bolts cut edge 40"m

S.A.E.		SOCIETÀ ANONIMA ELETTRIFICAZIONE	
P.A. 10000		P.A. 10000	
PUBLIC POWER CORPORATION		PUBLIC POWER CORPORATION	
GREECE		GREECE	
330kV Acheloos - Athens Trans Line		330kV Acheloos - Athens Trans Line	
330kV Salomoni - Thessaloniki Trans Line		330kV Salomoni - Thessaloniki Trans Line	
TYPE Z5 TOWER		TYPE Z5 TOWER	
SECTIONS D-D & E-E & F-F		SECTIONS D-D & E-E & F-F	
STRAIN & DEAD END TOWER		STRAIN & DEAD END TOWER	
DESIGNED BY: S.A.E.		DESIGNED BY: S.A.E.	
CHECKED BY: S.A.E.		CHECKED BY: S.A.E.	
DATE: 18.12.80		DATE: 18.12.80	
SCALE: 1:50		SCALE: 1:50	
P.44140		P.44140	